

Saramonic

4-in-1 Wireless Microphone System

四合一无线麦克风系统

Blink500B2+

User Manual

用户手册

Statement

Please read this manual carefully before using and strictly operate and store it in accordance with the instructions. Please save the manual for your future reference. If you need further assistance than the user manual, please consult your retailer for help or email us: info@saramonic.com

Cautions

1. DO NOT remove the housing yourself.
2. Please keep it away from heat sources such as radiators or spotlights.
3. Do not remove the battery without professionals' help.
4. Please clean the device with only a soft, dry cloth.
5. When using and storing, please keep away from dust and moisture places.
6. For the best pick-up pattern, do not hold your hand against the microphone capsule cover.

General Introduction

The Blink500B2+ is a portable 2.4GHz wireless microphone system. It features high-performance noise cancellation, which is available for improving the recording effect in a noisy environment. The Blink500B2+ is perfect for live streaming, vlogging, mobile journalism, and more. What's more, equipped with a low-cut filter, the wireless microphone can eliminate unwanted low-frequency noise (75Hz/150Hz or lower) in your recording.

Built-in omnidirectional microphone, the small and light transmitter features 360-degrees of sound pickup. A 3.5mm TRS output, USB-C, and iOS Lightning adapters allow the receiver to connect with cameras, mixers, smartphones, tablets, laptops, and more. The receiver has a USB-C charging port that supports charging and powering the device while using it with the adapters.

Features

- Up to 150 meters of wireless transmission
- Separate noise cancellation control - 48kHz HD audio format retained
- Wide-range 20-20,000Hz frequency response - deliver exceptional high-quality sound
- Low-cut filter(75Hz/ 150Hz) - cut off low-frequency noise from common
- Up to 20 hours of operating time for a transmitter and 16 hours for a receiver
- Comes with a windproof capsule - minimize unwanted wind noise
- Attach the transmitter can be to your clothes with the included magnet
- Receiver's 3.5mm headphone output - monitor your audio in real-time
- High-resolution OLED display - see vital information at a glance
- Mono/ Stereo/ Safety Track output setting
- 3.5mm TRS analog output, USB-C and iOS Lightning digital output - universal compatibility with cameras, smartphones and computers
- Charging case included - make the kit easy to carry on

Product Structure

Transmitter

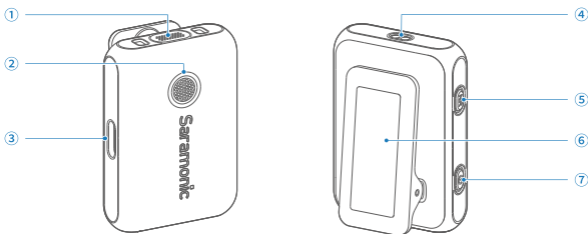

① Built-in Microphone Capsule

The capsule is fabricated with a windproof diaphragm, which can minimize unwanted wind noise and handling noise, etc.

② Status Indicator

Status	Indicator
Unpaired	Blinking blue slowly
Pairing	Blinking blue rapidly
Paired successfully	Static blue
Microphone muted	Blinking red slowly
Noise cancellation enabled	Static green
Low battery	Blinking red rapidly
Charging	Static red
Fully charged	Red light off (current status indicator)

NOTE: Please charge the transmitter when TX indicates low battery status, or it will automatically shut off within 10 minutes.

③ USB-C Charging Port

④ Charging Contacts

⑤ Noise Cancellation Button

Press to enable or disable the noise cancellation.

⑥ Belt Clip

⑦ Power Button

- Press and hold for 2 seconds to power on or off.
- Press to mute or unmute the microphone.
- Press and hold for 5 seconds to enter the pairing state in shutdown mode.

Receiver

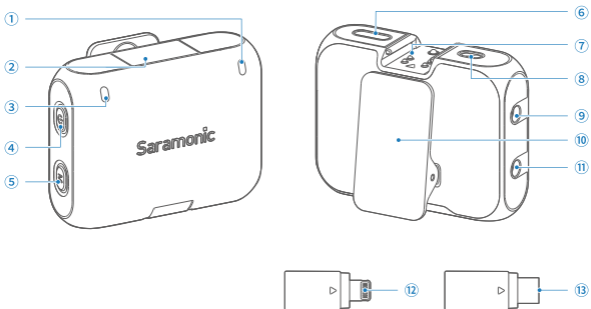

① Status Indicator for Channel A

Status	Indicator
Unpaired	Blinking blue
Pairing	
Paired successfully	Static blue

② OLED Screen

③ Status Indicator for Channel B

Status	Indicator
Unpaired	Blinking blue
Pairing	
Paired successfully	Static blue

④ Power Button

- Press and hold for 2 seconds to power on or off.
- Press to access the options of the gain. Refer to "Receiver's Screen Operations" for more details.

⑤ M Button

For setting values or functions in the receiver's menu. Refer to "Receiver's Screen Operations" for more details.

⑥ USB-C Charging Port

For charging the receiver. An external device can be powered and charged through this port while the receiver with a USB-C or iOS Lightning adapter is plugged into it.

⑦ Connecting Contacts

⑧ Charging Contacts

⑨ 3.5mm TRS Output

For analog audio output to a camera, mixer or recorder, etc.

⑩ Belt Clip

⑪ 3.5mm TRS Headphones Port

Connect your headphones to monitor the audio output in real-time of the audio.

⑫ MFi Certified Lightning Adapter

It can be connected to an iOS Lightning device.

⑬ USB-C Adapter

It can be connected to Android Smartphones, Tablets, Computers and other USB-C devices.

Charging Case



① Charging Indicator

Status	Battery Level	Indicator
Low battery	< 10%	⊙ ○ ○ ○
Charging	< 25%	⊙ ○ ○ ○
	25%~50%	● ⊙ ○ ○
	50%~75%	● ● ⊙ ○
	75%~100%	● ● ● ⊙
Fully charged	100%	● ● ● ●

② USB-C Charging Port

Receiver's Screen Operations

Home Screen Overview









From the Home screen, press the power button to access the options of the A , B channel gain or the output volume→ press the M button to adjust the value → press the power button again to save the setting.

	Indicates that the receiver is in Mono, Stereo, or Safety Track output mode.
	Sounds that are 75Hz (150Hz) or lower will be filtered.
	Indicates the receiver's output volume from 0 to 6. Default to 5.
	Indicates that channel A/ B is connected.
	Indicates the wireless signal strength between transmitter and receiver.
	Indicates that the current channel is disconnected.
	Microphone is muted.
	Indicates that the noise cancellation of the transmitter has been enabled and the feature's effect is strong or weak.
	Indicates the corresponding transmitter's mic gain from -6 to +9. Default to +7.
	Indicates current audio input level.
	Upper right corner: Indicates the receiver's battery level.
	Both sides: Indicates the corresponding transmitter's battery level.

Menu Introduction

- To access the menu page, press the M button. Continue to press the M button to turn the page and press the power button twice to return to the Home screen.
- From the menu page, press and hold the M button to access options→press the M or power button to set values or functions. →Press and hold the M button to save a new setting. Or press the power button twice to exit the setting and remain unchanged option.
- If no operation is performed within 20 seconds on the menu page, the display will automatically return to the Home screen.

Main Menu	Sub Menu	Indicator
Speaker	Enable	Once your phone's speaker is enabled, sound can be played directly without unplugging the receiver inserted into an adapter. The phone's speaker is disabled by default.
	Disable	
Output Volume	 0~6	The output gain level of the receiver can be reduced if the sound is distorted. The setting is retained even after the power is turned off. (Default to 5)
Noise Reduction	 Weak	Default to weak effect for noise cancelling.
	 Strong	
TX Mute Key	 Enable	The mute control of the transmitters' power button is activated.
	Disable	The mute control of the transmitters' power button is deactivated to prevent inadvertent operation.
Low Cut	 75Hz	Sounds that are 75Hz or lower will be filtered.
	 150Hz	Sounds that are 150Hz or lower will be filtered.
	Off	The low-cut filter is turned off by default.

Output Mode	M Mono	Signal from the transmitter or both transmitters can be mixed together and recorded identically to the left and right tracks.
	S Stereo	Signals from each transmitter can be recorded to a separate track.
	 Safety Track	Similar to Mono mode, the audio of the right track will be recorded in -6dB in case of distortion in your recordings.
Backlight	On	The backlight always stays on. (Default setting)
	10s	The backlight will turn off if no operation occurs for 10 seconds.
	30s	The backlight will turn off if no operation occurs for 30 seconds.
	60s	The backlight will turn off if no operation occurs for 60 seconds.
Language	简体中文	Default to English.
	English	
Reset Default	Yes?	After selecting Yes, the receiver's relevant parameters will be restored to the default factory values. (Please use it with caution.)
	No?	
Pair	Yes?	After selecting Yes, the receiver will enter the pairing state.
	No?	
Version	Indicates the receiver's software version.	

How to Use

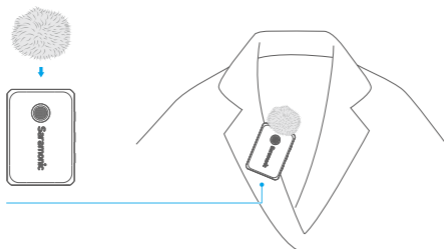

1. The transmitter comes with a windproof capsule. It can fit an extra fur windshield when you need to enhance wind protection outdoors or in a windy environment.

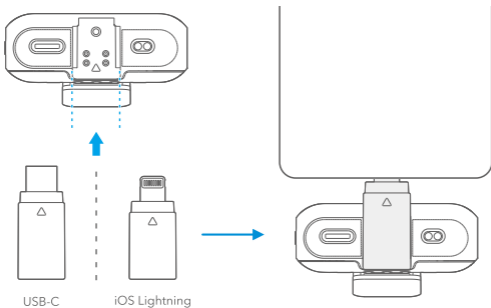

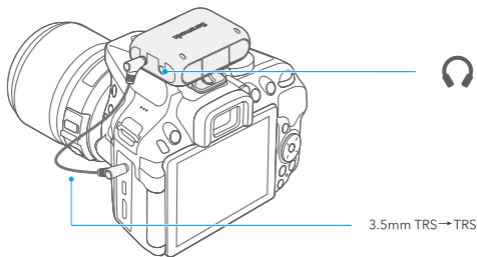

2. Push the selected adapter into the receiver, and then connect the receiver to your smartphone, tablet, computer, or other mobile devices. Or connect a camera or a mixer to the 3.5mm TRS audio output of the receiver with an adapter cable.
3. Press and hold the power buttons for 2 seconds to turn on the transmitter(s) and receiver.

4. Pairing

The transmitter(s) and receiver are paired by default. If they are disconnected, please follow the below steps:

- ① Press the receiver's M button until you turn to the "Pair" menu page.
- ② Press and hold the M button to access the options→press to select "Yes?"→press and hold again to save the settings.

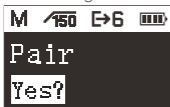

- ③ To make the transmitter(s) enter the pairing state, press and hold its power button for 5 seconds in shutdown mode until its status indicator blinks blue rapidly.
 - ④ Transmitter(s) and receiver will be successfully paired within 10 seconds. The transmitter's information and status will be shown on the receiver's screen.
5. Plug your headphones into the receiver's 3.5mm headphone port for audio monitoring as your need.
 6. Set Mono, Stereo or Safety Track mode on the receiver's menu as your need.
 7. It is recommended to record a sample and play it back to check if the audio level is acceptable before recording.

8. In order to improve the recording effect in a noisy environment, it is recommended that press the **(NR)** button on the transmitter(s) to enable noise cancellation.

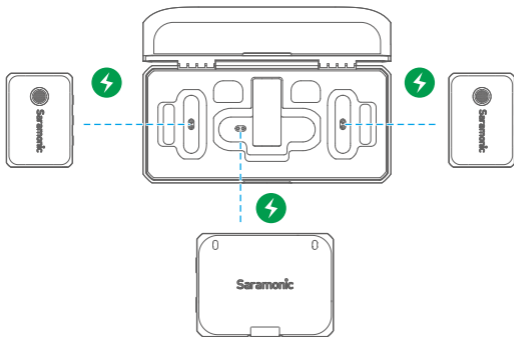

9. After recording, put the transmitter(s) and receiver back into the case for charging.

NOTE:

- ① If a certain transmitter of Blink500B2+ failed to pair, please turn off the paired transmitter, and then reconnect the unpaired transmitter and receiver.
- ② Due to the 2.4GHz wireless frequency is widely used, the signal may be easily attenuated or interfered. Please try to avoid obstacles while using, such as walls and buildings. And keep away from the devices with 2.4GHz frequency, such as high-power Wi-Fi antennas, radios, etc.

Troubleshooting

If you encounter problems when using the unit, please refer to the following checklist before contacting technical support. If the problem cannot be solved, please contact the dealer's after-sales service department.

- **If there is no sound from the unit or no sound when connected to an external device**
 - ① Make sure the receiver or the adapter on the receiver is well connected to your device. Or remove the adapter and wipe the charging contacts with a clean cloth.
 - ② Make sure the mic gain or output volume is not turned to the minimum.
 - ③ Make sure the transmitter is not muted.
- **If the sound of the unit is too low or too loud or even distorted**
 - ① Adjust mic gain and output volume to the suitable level for recording in the current environment to improve the recording effect.
 - ② If you are recording in noisy environment, it is recommended to enable noise cancellation to improve the recording effect.
- **Current noise or other abnormal noise appears during monitoring**

Make sure there is no interference near the unit. If the noise still exists after changing the unit's position, please contact our customer service.
- **Howling noise occurs when using the receiver with an adapter**

Make sure your phone's speaker is disabled in the receiver's menu.
- **The operating range of the unit is limited and the sound is frequently intermittent**

Make sure there is no interference between the transmitter(s) and the receiver. If the intermittent sound still occurs frequently, please contact our customer service.
- **Failed to charge the transmitter(s) or receiver via the charging case**
 - ① Make sure the charging contacts of both are in full contact. Wipe the charging contacts with a clean cloth and try again.
 - ② If you want to check whether the magnetic force is aging or whether the charging contacts of the two are not in sufficient contact, press the transmitter(s)/receiver placed in the charging case to check whether it is in a charging state. If the transmitter(s) or the receiver is still failed to be charged, please contact our customer service.

Specifications

Transmitter

Transmission Type	2.4GHz digital frequency
Modulation	GFSK
Polar Pattern	Omnidirectional
Operating Range	Up to 150m (Measured in open environment without obstacles and interference.)
RF Output Power	<10dBm
Frequency Response	20Hz-20kHz
Reference Audio Input Level	-30~-42dBV (MIC input, 0dB gain)
Sampling/ Bit Rate	48kHz/ 24bit
Sensitivity	-32dB±3dB (1V/Pa)
Signal-to-Noise Ratio	>80dB
Distortion	<0.10%
Audio Input	Built-in microphone capsule
Power Requirements	Built-in lithium-ion battery/ Charging contacts/ USB-C charging port (DC 5V)
Battery Capacity	190mAh
Battery Life	Approx. 20 hours
Charging Time	Approx. 2 hours
Weight	Approx. 23g
Dimensions	45mm×31.6mm×13mm
Operating Temperature	0°C to +50°C
Storage Temperature	-10°C to +50°C

Receiver

Display	OLED
Transmission Type	2.4GHz digital frequency
Modulation	GFSK
Operating Range	Up to 150m (Measured in open environment without obstacles and interference.)
RF Output Power	<10dBm
Frequency Response	20Hz-20kHz
Sampling/ Bit Rate	48kHz/ 24bit
Signal-to-Noise Ratio	>80dB
Distortion	<0.10%
Audio Output	3.5mm TRS output/ MFi certified lightning adapter/ USB-C adapter
Monitor Port	3.5mm TRS headphone port
Power Requirements	Built-in lithium-ion battery/ Charging contacts/ USB-C charging port (DC 5V)
Battery Capacity	400mAh
Battery Life	Approx. 16 hours
Charging Time	Approx. 2 hours
Weight	Approx. 30g
Dimensions	49.5mm×37.5mm×18.8mm
Operating Temperature	0°C to +50°C
Storage Temperature	-10°C to +50°C

Charging Case

Battery Capacity	1250mAh
Charging Time	Approx. 2 hours
Charging Connector	USB-C charging port (DC 5V)
Times for Charging Microphone	1times (2*TX+1*RX)
Weight	Approx. 140g
Dimensions	118.5mm×56.2mm×62mm
Operating Temperature	0°C to +50°C
Storage Temperature	-10°C to +50°C

In the Box

Transmitter ×2

Receiver ×1

Charging Case ×1

USB-C Adapter ×1

MFi Certified Lightning Adapter ×1

USB-A to USB-C Cable ×1

3.5mm TRS to 3.5mm TRS Audio Cable ×1

3.5mm TRS to 3.5mm TRRS Audio Cable ×1

Fur Windshield ×2

Magnet ×2

Carrying Pouch ×1